



VAAAT | center



About **VAAT YAPI**

As Vaat Yapi:

We promise to follow all innovations, technological developments, and trends in the real estate industry and construct affordable, comfortable, and high-income properties for our customers.

We use environmentally friendly construction materials and produce real estate projects that leave marks with their aesthetics and functionality.



Handwritten architectural notes in the top left corner, partially obscured by a red overlay.

Are you ready
TO DISCOVER VAAT CENTER?



About VAAT CENTER

At Vaat Center.

We aim to offer you a more comfortable life than similar projects by saving your time with the proximity of Vaat Center to universities providing high standards of education, fully equipped hospitals, Istanbul's biggest shopping malls, public transport networks, Istanbul Airport, and Canal Istanbul.



VAAT CENTER

is at the center of life

We planned a town on an area of 25.000 m² with every detail carefully thought out. You will be at the center of everything you need in our Vaat Center project, which consists of 650 residences, 37 stores, and a 5-Star Hotel.

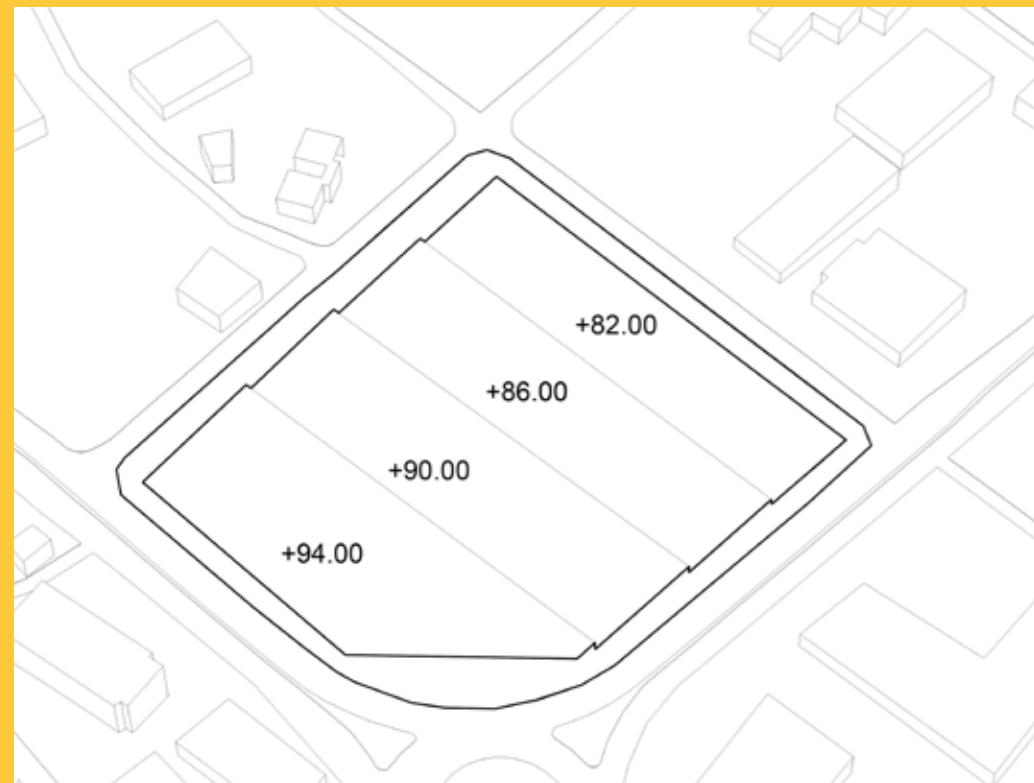

A location with an investment
value of constantly rising:
BASIN EXPRESS

10

VAA T center

VAA T center



- M1B Kırazlı (*Halkalı) - Yenikapı Subway line
- M3 Kırazlı - Başakşehir/Metrokent (*Kayaşehir) Subway line
- M7 Mecidiyeköy (*Kabataş) - Mahmutbey (*Esenyurt) Subway line
- M9 Bahariya (*Ataköy) - Olimpiyat Subway line
- T1 Kabataş - Bağcılar Tram line
- E-5 — TEM — Basın Express

Wherever you want to be,
**YOU ARE CLOSE TO IT. BECAUSE YOU ARE AT
VAAT CENTER.**

TRANSPORT

İstanbul Havalimanı	20 km
TEM Otoyolu	1 km
E-5 Yolu	4 km
Kanal İstanbul Projesi	5 km
Basın Express Yolu	1 km

SHOPPING

Mall of İstanbul	2 km
212 Power Outlet	1 km
İstinye Park	20 km
Zorlu Center	13 km

TOURISTIC PLACES

İstiklal Caddesi	15 km
Ayasofya Camii	12 km
Çamlıca Camii	25 km
Ortaköy Camii	20 km

HEALTH

Çam ve Sakura Şehir Hastanesi	4 km
Medipol Mega Hastanesi	1 km

EDUCATION

Altınbaş Üniversitesi	150 m
-----------------------	-------



EVERY SINGLE DETAIL WILL
make you feel special



WIDE SPACING BETWEEN BUILDINGS
provides a spacious living space

SHOPPING STREETS

SOCIAL FACILITIES



THE SHOPPING SQUARE

OUTDOOR SWIMMING POOLS

5-STAR HOTEL

CAFES AND RESTAURANTS

1+1 A



- 1 Living Room + Kitchen 28,87 - 31,13 m²
- 2 Entry Hallway: 2,22 - 2,39 m²
- 3 Bedroom: 12,06 - 13,00 m²
- 4 Bathroom: 4,50 - 4,85 m²
- 5 Balcony: 5,29 - 5,71 m²

Net: 52,94 - 57,08 m²
Gross: 87,97 - 93,56 m²

Dedicated Warehouse: 4,00 m²
Dedicated Parking: 1 piece

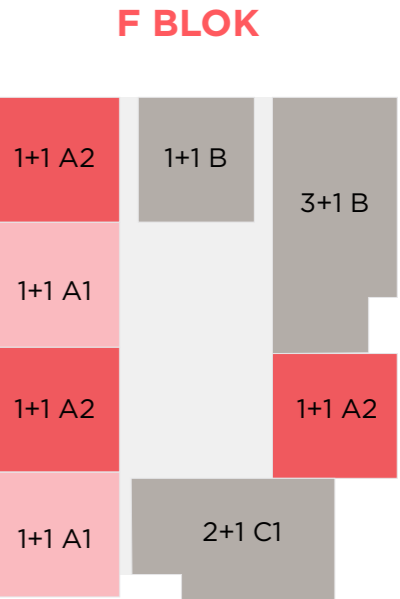
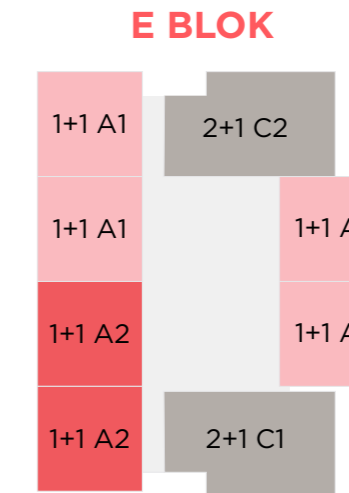
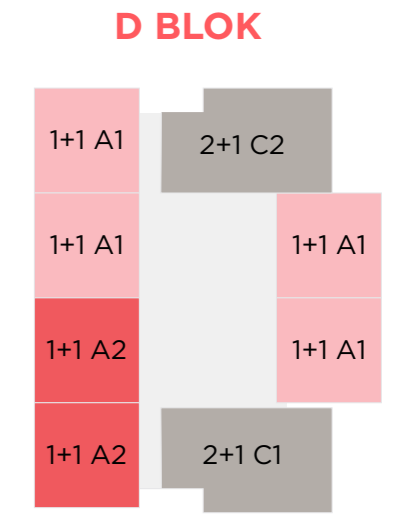
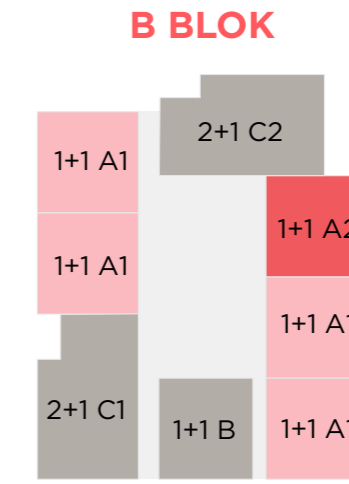
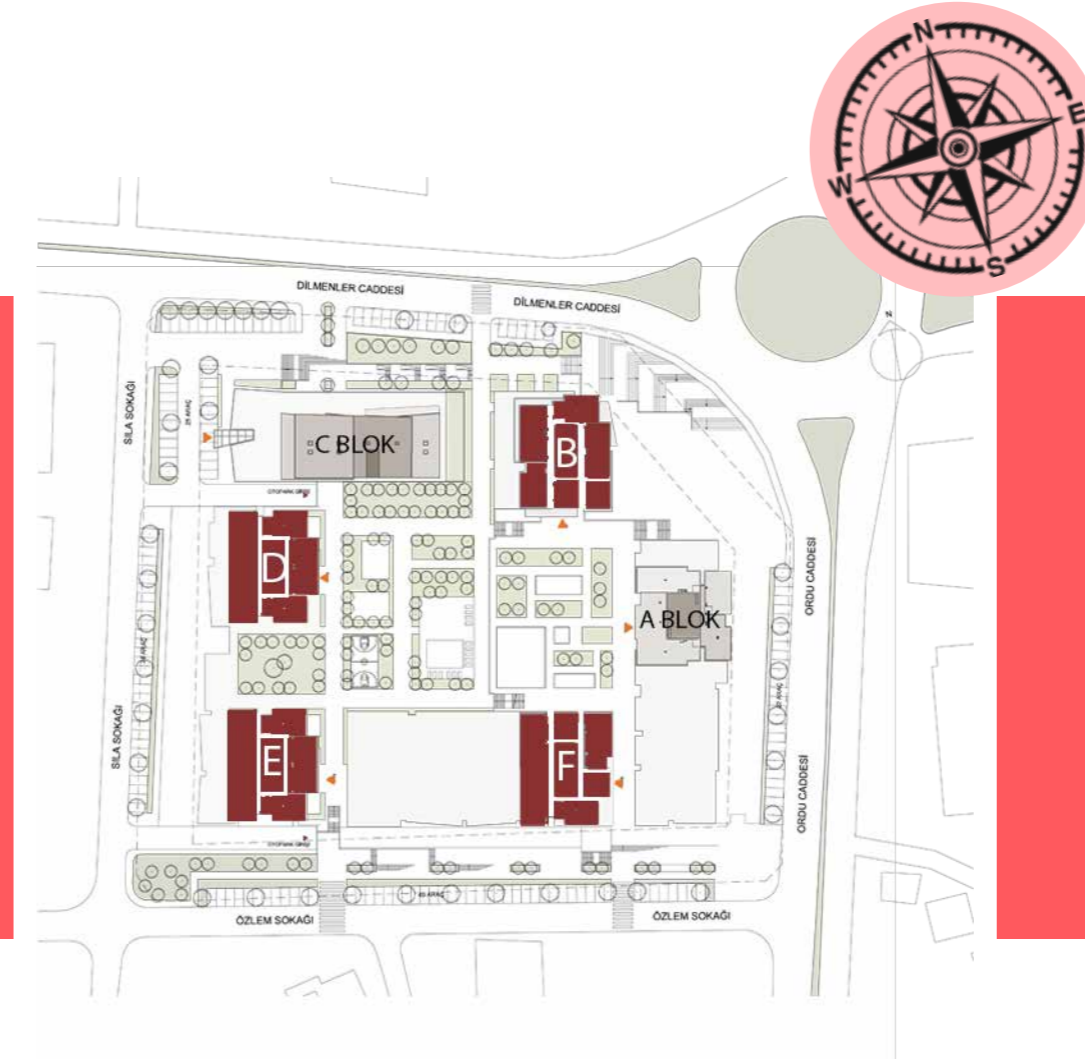

* This flat plan is not-to-scale. Depending on the technical and legal obligations, the Real Estate Development Company may make amendments to the project. The household goods shown in the flat plan are placed as a representation, and no good will be delivered other than the products and goods specified in the Technical Specifications.

1+1 B



- 1 Living Room + Kitchen 30,34 m²
- 2 Bedroom: 15,06 m²
- 3 Bathroom: 4,73 m²
- 4 Balcony: 3,77 m²

Net: 53,90 m²
Gross: 89,27 m²

Dedicated Warehouse: 4,00 m²
Dedicated Parking: 1 piece

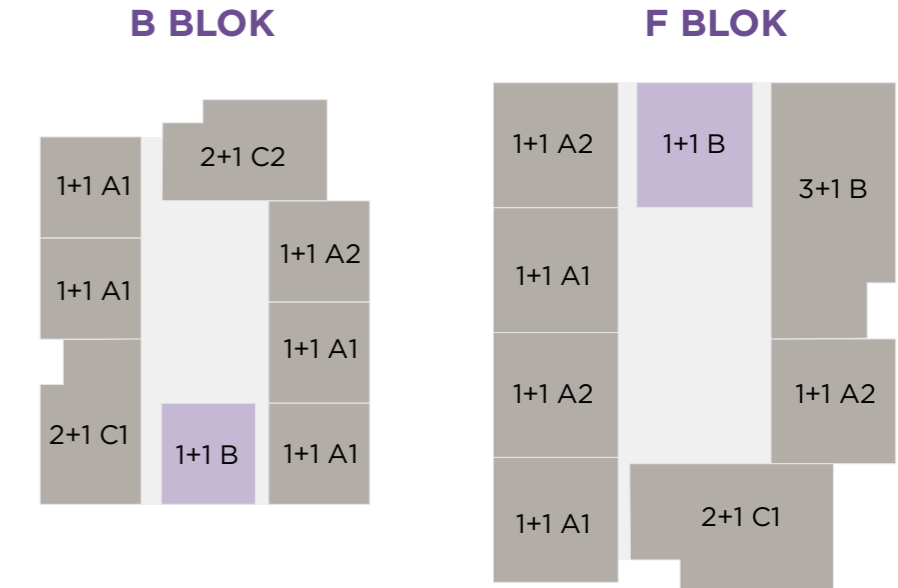
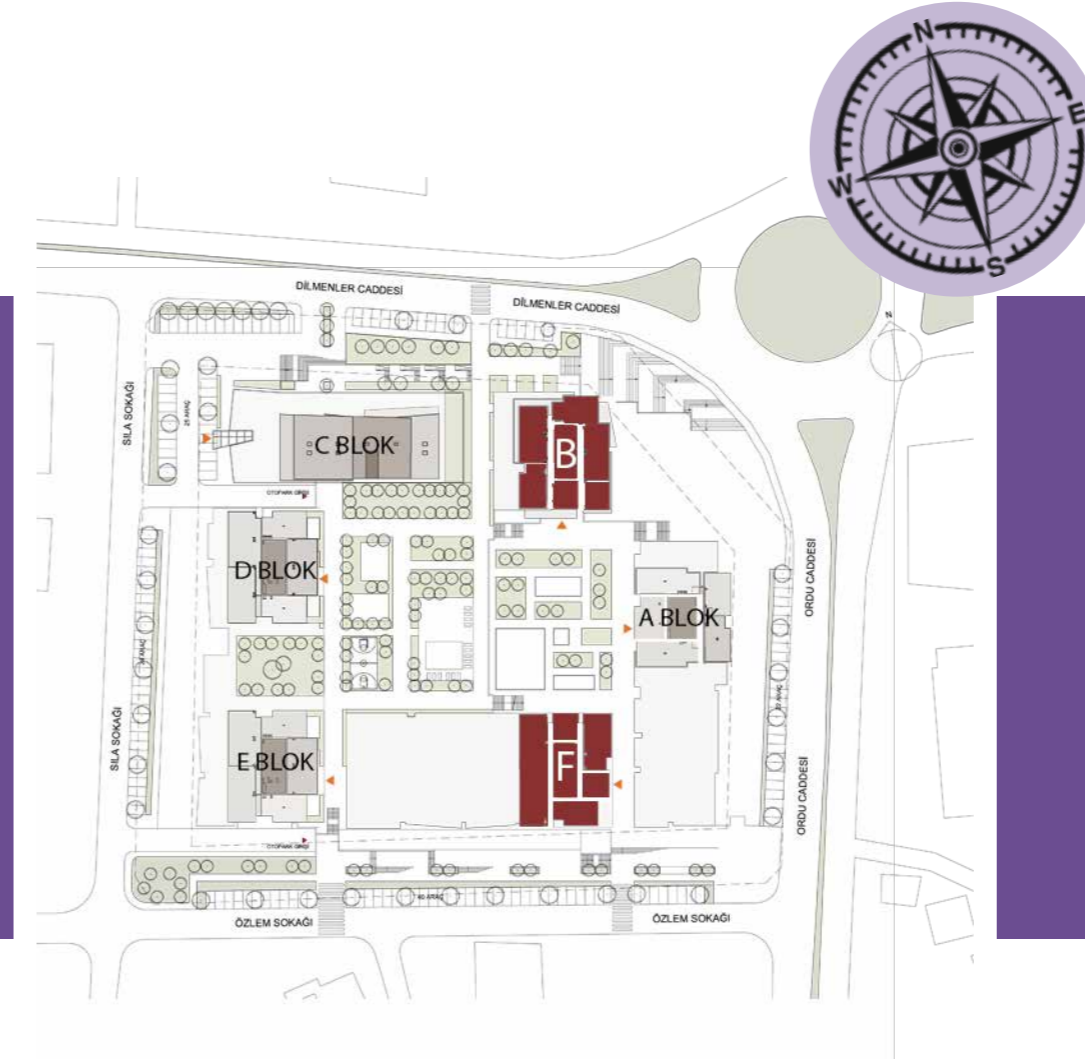

* This flat plan is not-to-scale. Depending on the technical and legal obligations, the Real Estate Development Company may make amendments to the project. The household goods shown in the flat plan are placed as a representation, and no good will be delivered other than the products and goods specified in the Technical Specifications.

2+1 A

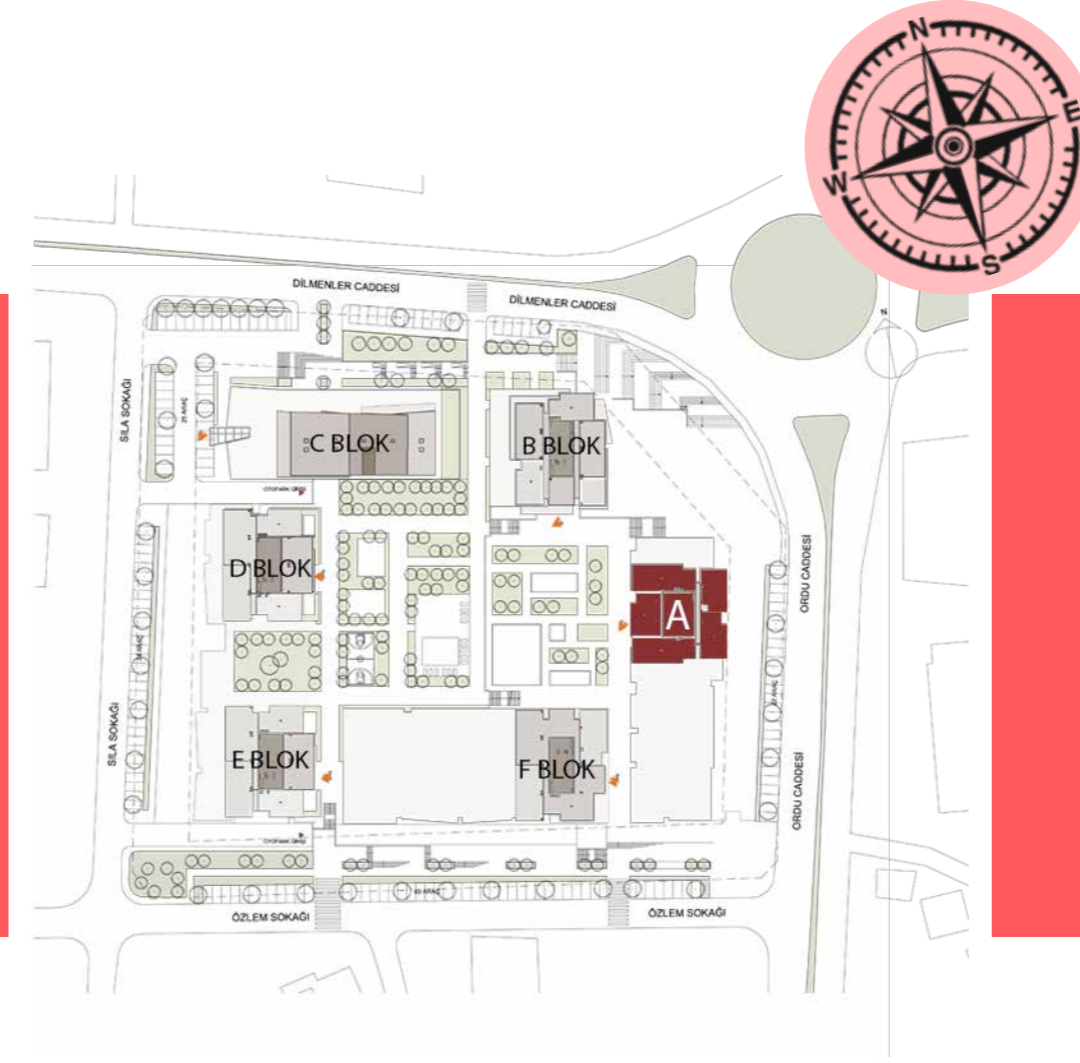

A BLOK

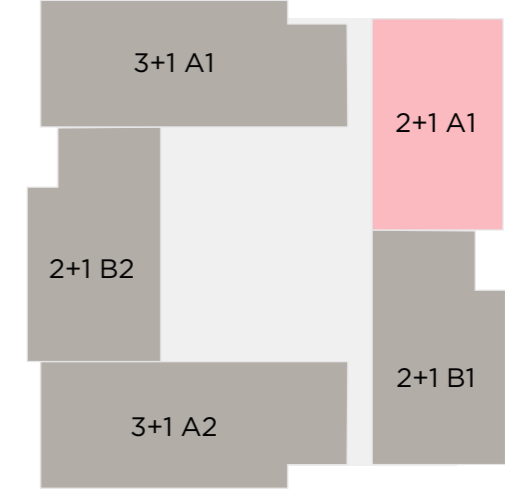

1	Entry Hallway:	3,59 m ²
2	Living Room + Kitchen:	25,39 m ²
3	Corridor:	4,89 m ²
4	2nd Room:	10,93 m ²
5	Bedroom:	20,33 m ²
6	Bathroom:	4,74 m ²
7	Balcony:	8,61 m ²

Net:	78,48 m ²
Gross:	122,45 m ²

Dedicated Warehouse	4,00 m ²
Dedicated Parking:	1 pieces

* This flat plan is not-to-scale. Depending on the technical and legal obligations, the Real Estate Development Company may make amendments to the project. The household goods shown in the flat plan are placed as a representation, and no good will be delivered other than the products and goods specified in the Technical Specifications.



25

2+1 B

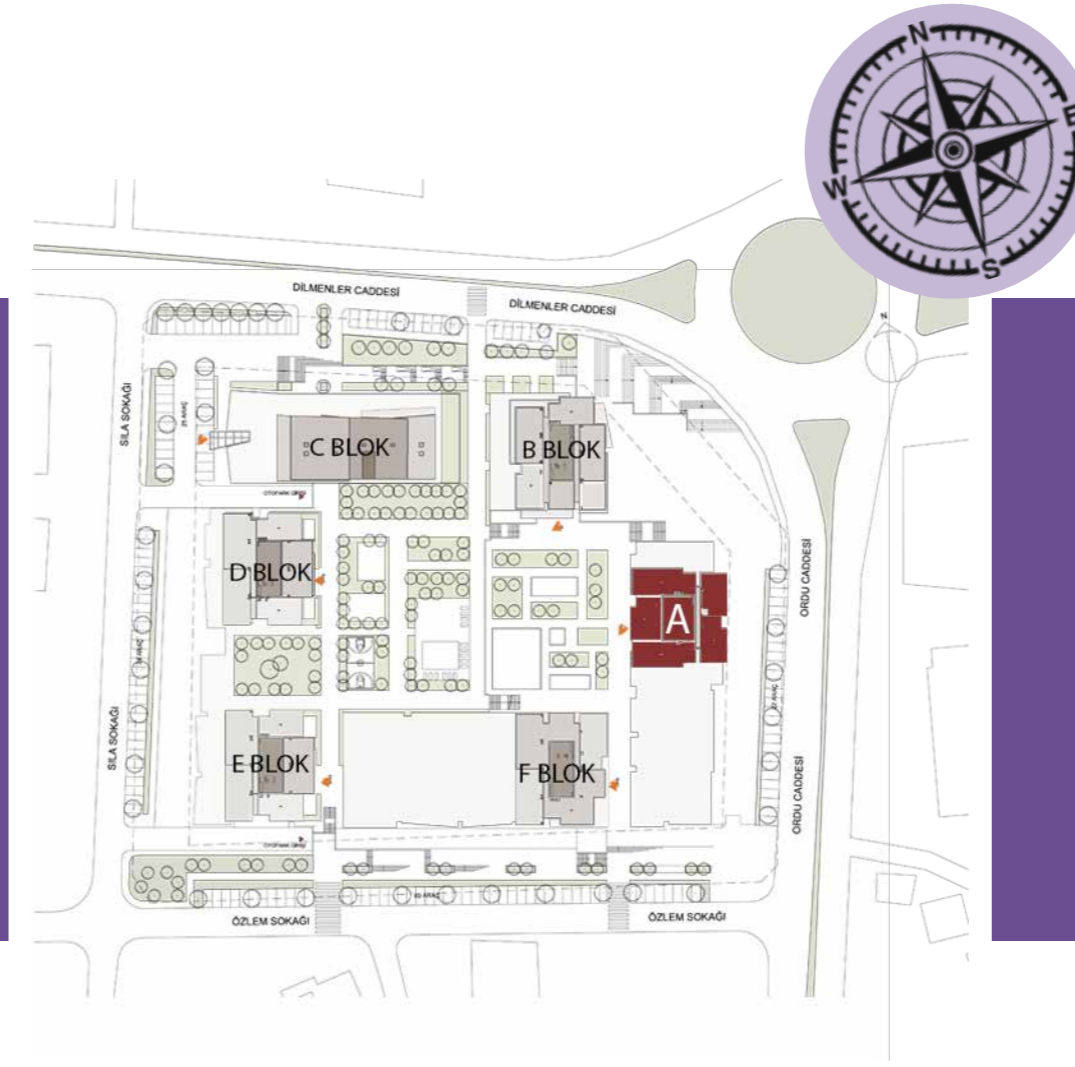

A BLOK

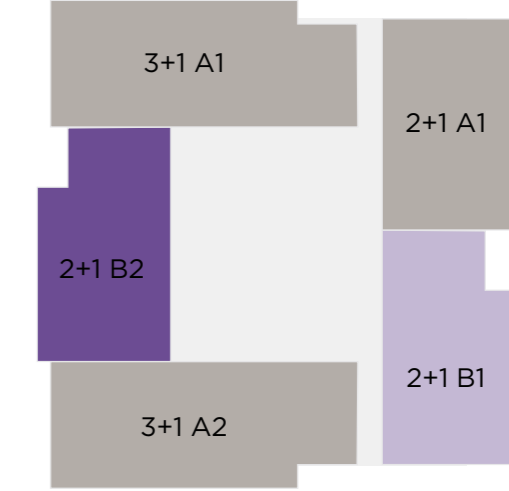

- 1 **entry hallway:** 7,76 m²
- 2 **Living Room:** 25,55 m²
- 3 **Corridor:** 2,91 m²
- 4 **2nd Room:** 9,71 m²
- 5 **Bedroom:** 12,51 m²
- 6 **Bathroom:** 4,84 m²
- 7 **Ensuite Bathroom:** 4,66 m²
- 8 **Indoor Kitchen:** 10,26 m²
- 9 **Balcony:** 6,08 m²

Net: 84,28 m²
Gross: 130,28 m²

Dedicated Warehouse: 4,00 m²
Dedicated Parking: 1 pieces



* This flat plan is not-to-scale. Depending on the technical and legal obligations, the Real Estate Development Company may make amendments to the project. The household goods shown in the flat plan are placed as a representation, and no good will be delivered other than the products and goods specified in the Technical Specifications.

2+1 C

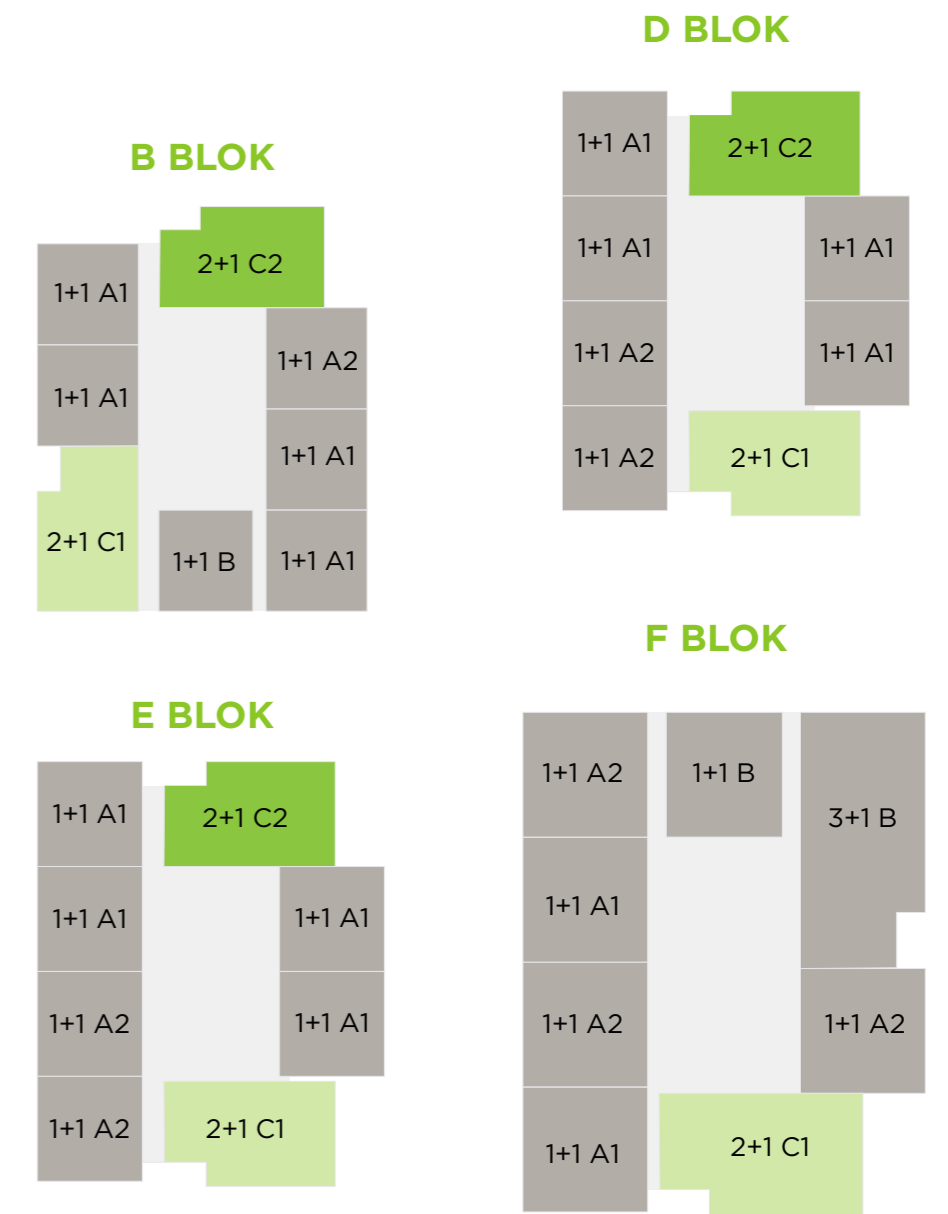
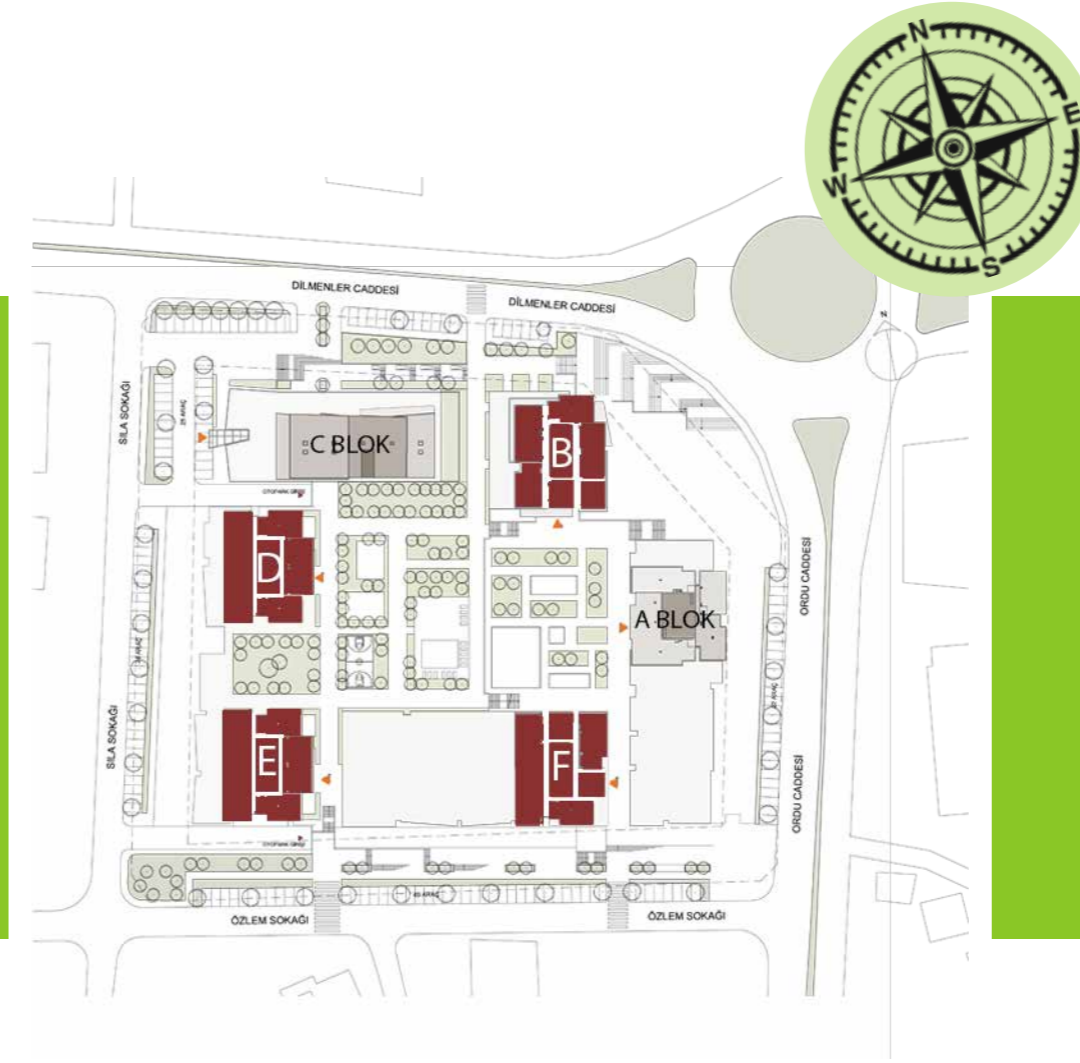

- 1 **Entry Hallway:** 7,31 - 8,38 m²
- 2 **Living Room:** 27,30 - 31,27 m²
- 3 **Corridor:** 2,95 - 3,38 m²
- 4 **2nd Room:** 9,61 - 11,00 m²
- 5 **Bedroom:** 16,21 - 18,56 m²
- 6 **Bathroom:** 4,58 - 5,24 m²
- 7 **Indoor Kitchen:** 9,46 - 10,83 m²
- 8 **Balcony:** 6,86 - 7,86 m²



Net: 84,28 - 96,52 m²
Gross: 130,28 - 146,80 m²

Dedicated Warehouse: 4,00 m²
Dedicated Parking: 1 pieces

* This flat plan is not-to-scale. Depending on the technical and legal obligations, the Real Estate Development Company may make amendments to the project. The household goods shown in the flat plan are placed as a representation, and no good will be delivered other than the products and goods specified in the Technical Specifications.



3+1 A

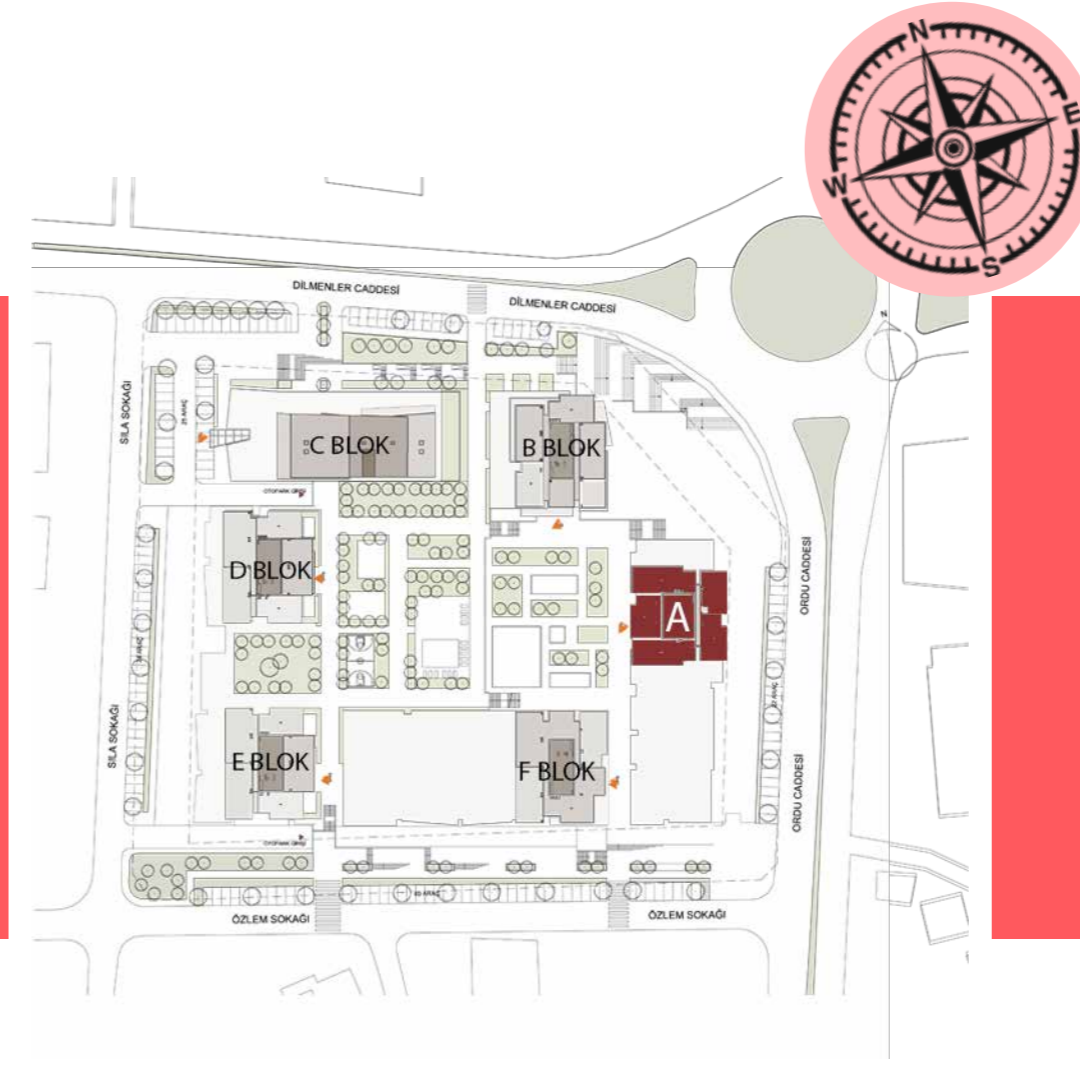

A BLOK

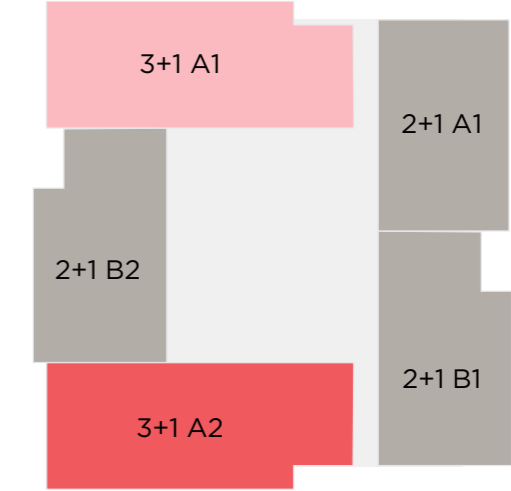

1	Living Room:	33,39 m ²
2	Entry Hallway:	9,73 m ²
3	Bathroom:	5,59 m ²
4	Laundry Niche:	1,81 m ²
5	Ensuite Bathroom:	4,10 m ²
6	Bedroom:	15,51 m ²
7	2nd Room:	10,44 m ²
8	3rd Room:	10,50 m ²
9	Indoor Kitchen:	10,05 m ²
10	Balcony:	8,84 m ²
11	Corridor:	5,00 m ²

Net:	114,96 m ²
Gross:	184,20 m ²

Dedicated Warehouse:	4,00 m ²
Dedicated Parking:	2 pieces



* This flat plan is not-to-scale. Depending on the technical and legal obligations, the Real Estate Development Company may make amendments to the project. The household goods shown in the flat plan are placed as a representation, and no good will be delivered other than the products and goods specified in the Technical Specifications.

3+1 B

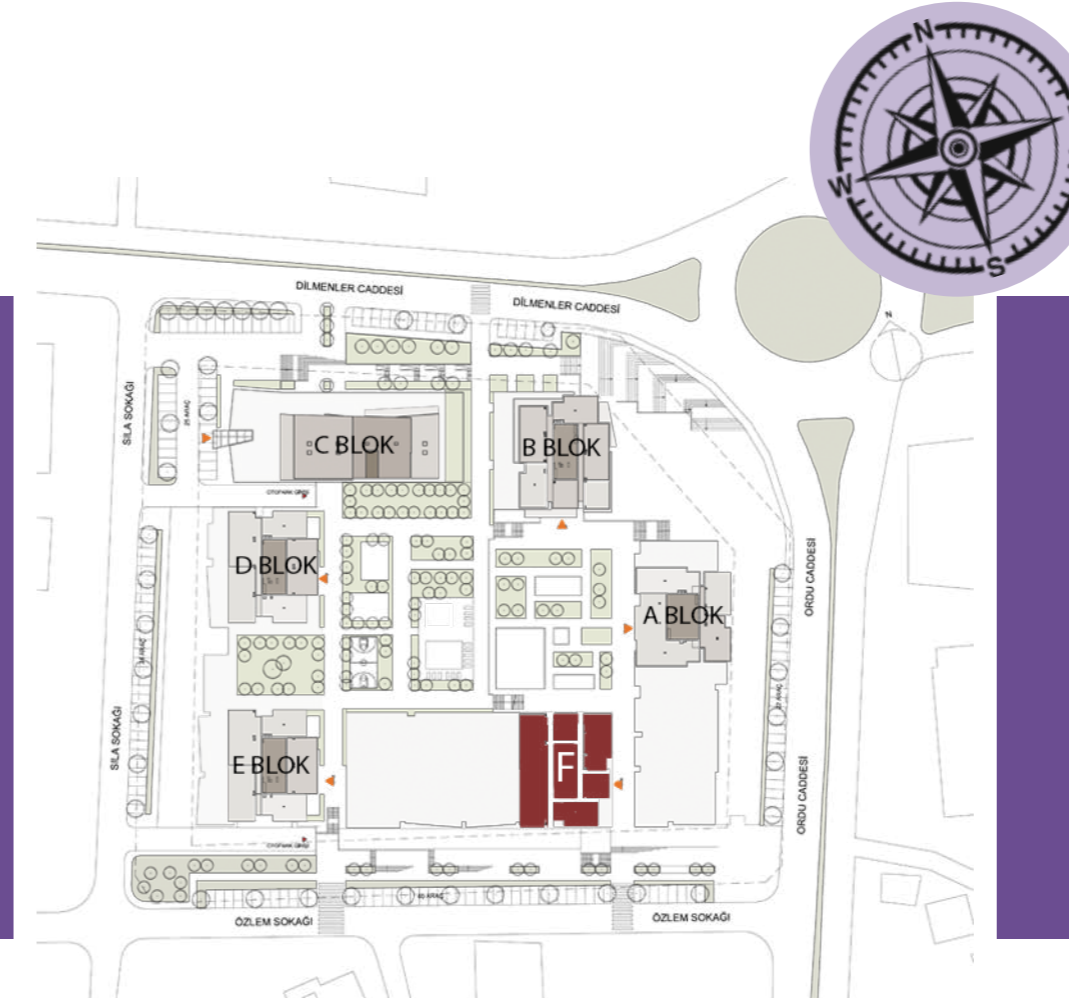

F BLOK

1+1 A2	1+1 B	3+1 B
1+1 A1		
1+1 A2		1+1 A2
1+1 A1	2+1 C1	

1	Entry Hallway:	7,49 m ²
2	Bathroom:	5,73 m ²
3	Laundry Niche:	1,75 m ²
4	Ensuite Bathroom:	5,33 m ²
5	Bedroom:	16,11 m ²
6	2nd Room:	11,00 m ²
7	3rd Room:	11,95 m ²
8	Living Room:	29,84 m ²
9	Balcony:	4,87 m ²
10	Indoor Kitchen:	12,22 m ²
11	Corridor:	4,60 m ²

Net:	111,09 m ²
Gross:	178,97 m ²

Dedicated Warehouse:	4,00 m ²
Dedicated Parking:	2 pieces

* This flat plan is not-to-scale. Depending on the technical and legal obligations, the Real Estate Development Company may make amendments to the project. The household goods shown in the flat plan are placed as a representation, and no good will be delivered other than the products and goods specified in the Technical Specifications.



33



HIGH CEILING

spacious interior design



LIVE AT THE CENTER OF LIFE,
away from the hustle and bustle of the city

VAAAT | center





HEALTH AND SPORTS

- Indoor and Outdoor Sports Fields
- Outdoor and Indoor Swimming Pools
- Gym and Wellness





- Sauna
- Steam Room
- Turkish Bath



HEALTH AND SPORTS





- Indoor and Outdoor Playgrounds
- Art Wall
- Skatepark
- Climbing Wall
- Bike Trails
- Mini Greenhouse Gardens

CHILD AND FAMILY





ENTERTAINMENT AND ACTIVITIES

- Open Air Cinema
- Mini Cinema
- Karaoke and Music Rooms
- Playstation Saloon
- Terrace Gardens
- Barbecue Terraces



ENTERTAINMENT AND ACTIVITIES





WORK AND LIFE

- Spacious Guest Suites
- Fully Equipped Meeting Rooms

SAFETY AND COMFORT

- Safety
- 7/24 Security Camera Monitoring
- Lobby
- Car Park
- Electric Vehicle Charging Stations





SHOPPING AND ACCOMMODATION
are one step away from you



5-star *hospitality*

We are rewriting the rules of hospitality with our 5-star hotel offering the most prestigious service understanding in Istanbul.

EASILY ACCESSIBLE *shopping.*

Shopping streets that meet your daily needs, a living space where you can have your coffee with your friends and have a pleasant time with your family are right under your home.



54

Vaat Holding is a group of companies that are constantly growing and aiming for the better with its investments in construction, tourism, and industry since 2015. Vaat Yapı is the locomotive company of the group and draws attention with its housing, hotel, and factory constructions in Trabzon, Samsun, and Istanbul.

Vaat Center, the Hotel/AVM/Residence mixed-use project of Vaat Yapı, will be built in Güneşli, Istanbul and would make a name for itself in the sector. Misal Hotels, Vaat Holding's tourism investments, have high occupancy rates and offer the highest quality service to their customers in all seasons.

The first of Vaat Holding's industrial investments is the Smogmoon Tobacco Factory. The flavored hookah tobacco products that we produce in this factory located in Trabzon Akçaabat are exported to many countries.

We offer Vaat Holding quality to our valued customers in the food industry also with our Fi Süt (Milk) brand.

About **VAAT HOLDING**



COMPLETED Projects

2016



Misal House Otel
7.000 m² / 32 Room

2017

**İnci Prime
(İş Ortaklığı)**
150.000 m²
612 B.Section



Vaat Yapı Head Office
1.000 m²



2018



New Trabzon
8.000 m² / 54 B.Section

2019



Misal Trabzon
28.000 m² / 120 B.Section

2020



Misal Room Hotel
9.000 m² / 120 Room



Smogmoon Tobacco Factory
1.500 m²

2021



Fi Milk Factory
5.800 m²

Konaklar Time
7.500 m² / 56 B.Section



ONGOING Projects

2022





Vaat Express
27.000 m² / 145 B.Section

2022



Misal Otel Basın Express
14.000 m² / 150 Room

 vaatyapi

 vaatyapi

 vaatyapi

info@vaat.com.tr
+90 212 656 90 90



www.vaatcenter.com

Sales Office Address: Mahmutbey Mahallesi Ordu Caddesi Bağcılar/İSTANBUL

Head Office Address: Mahmutbey Mah. Taşocağı Yolu Cad. Balance Güneşli İş Merkezi No:19/7 C Blok Kat:1 Bağcılar / İstanbul

Trabzon Office Address: Konaklar Mah. Barbaros Cad. No:39 Ortahisar / Trabzon

All images in this catalog are designed and used for illustrative purposes. Every effort has been made to ensure that the images truly reflect the project; however, Vaat Yapı reserves the right to change the images, plans, and other details in this project without prior notice. Details and furnishing presented in this catalog are optional if they are not included in the technical specification, contract annex, projects, and zone list. The application project (construction drawings) of the house you will purchase is the approved project attached to the construction permit for this project. In accordance with the contract and your technical specification annexed to the contract, the responsibility of Vaat Yapı is limited to the construction of the house. This catalog contains the project specifications at the time of printing. The equipment and features of the house on the date of sale will be specified in the preliminary sales contract and / or its annex. In case of a conflict between the preliminary sales contract and the catalog, the preliminary sales contract shall prevail.



VAAT
YAPI